

-  Clear waters
-  Domestic use
-  Civil use
-  Industrial use

※ **High-quality materials and robust construction ensure superior performance and reliability**



PERFORMANCE RANGE

- Flow rate up to **550 l/min** (33 m³/h)
- Head up to **41 m**

INSTALLATION AND USE

DC submersible pumps are constructed from thick cast iron, offering exceptional robustness, abrasion resistance, and longevity. Perfect for **draining both clear and slightly dirty water**, their durability and reliability set them apart. Designed for automated fixed installations, the DC series guarantees continuous operation, even in conditions where they are not fully submerged.

INCLUDES

- ※ Power cable length **10 m**
- ※ Float switch (exclusive to single-phase models)
- ※ Switchbox compatible with DCm42, DCm43 (exclusive to single-phase models)

APPLICATION LIMITS

- Maximum operating depth below water level up to **10 m** (with an appropriately sized power cable)
- Liquid temperature up to **+40 °C**
- Capable of processing suspended solids up to **Ø 10 mm**
- Draining capability **25 mm**
- **Minimum immersion for continuous service 300 mm**

AVAILABLE UPON REQUEST

- ※ Different voltage or frequency

WARRANTY

- ※ **The warranty for the Three-Phase models remains valid only if the motor's built-in thermal protector is properly connected to the control panel. This connection is essential for the warranty's applicability**

PATENTS - TRADE MARKS - MODELS

- Patent No. IT0001428923
- Registered Community Model No. 002501486-0001

CURVES AND PERFORMANCE DATA

60 Hz

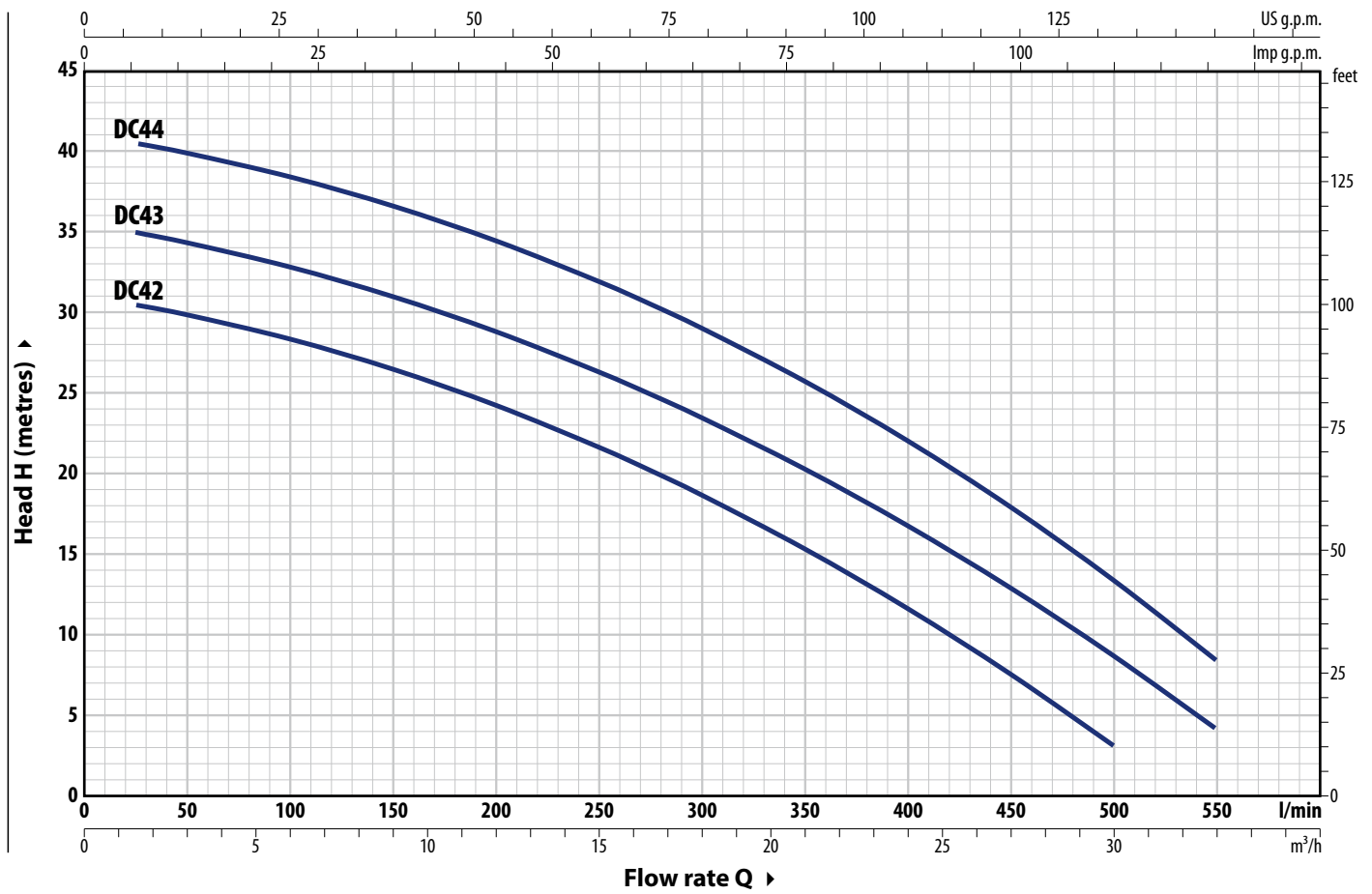

TYPE		POWER (P ₂)		Q	Flow rate (l/min)																
Single-ph.	Three-ph.	kW	HP		0	1.5	3.0	6.0	9.0	12.0	15.0	16.5	18.0	21.0	24.0	27.0	30.0	33.0			
DCm 42	DC 42	1.5	2	H m	31	30.5	30	28.4	26.5	24.3	21.6	20.2	18.6	15.3	11.6	7.5	3				
DCm 43	DC 43	2.2	3		35.5	35	34.4	33	31	28.8	26.3	25	23.5	20.3	16.7	12.8	8.5	4			
-	DC 44	3	4		41	40.5	39.9	38.4	36.6	34.4	31.9	30.5	29	25.7	22.1	18	13.5	8.5			

Q = Flow rate H = Total manometric head

Performance curves comply with EN ISO 9906 Grade 3B tolerance limits.

ABSORPTION

TYPE	VOLTAGE
Single-phase	220 V
DCm 42	14.0 A
DCm 43	18.0 A

TYPE	VOLTAGE	
	380 V	440 V
DC 42	5.2 A	4.6 A
DC 43	7.5 A	6.6 A
DC 44	8.5 A	7.5 A

DIMENSIONS AND WEIGHT

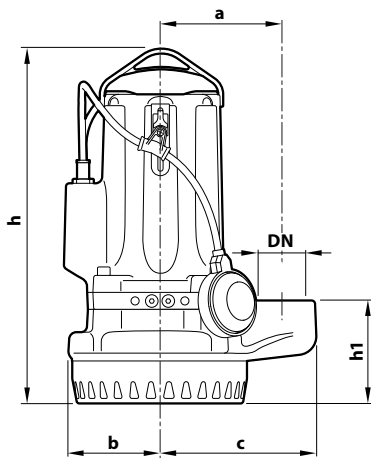

Typical installation

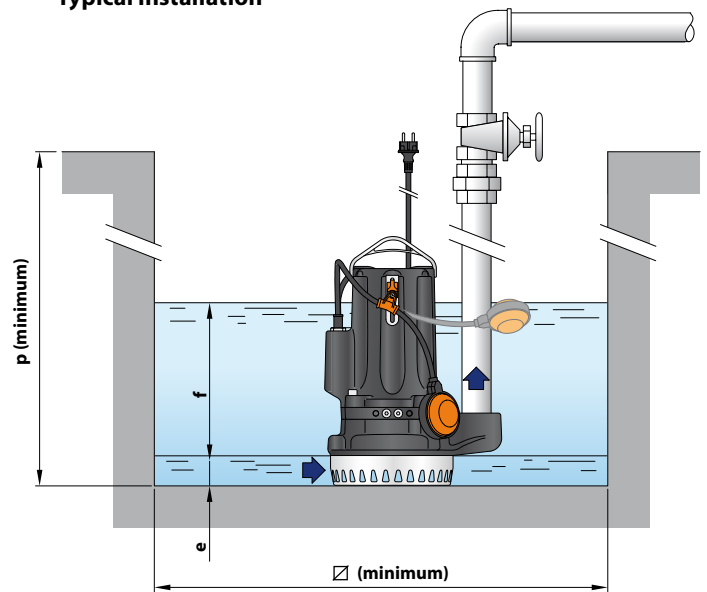

TYPE		PORT DN	DIMENSIONS mm										kg	
Single-ph.	Three-ph.		a	b	c	d	h	h1	e	f	p	Ø	1~	3~
DCm 42	DC 42	2"	150	112	190	230	434	125	25	adjustable	800	800	42.0	41.0
DCm 43	DC 43						460 434						47.0	42.0
-	DC 44						460						-	47.0

PALLET CAPACITY

TYPE		GROUPAGE n. pumps	CONTAINER n. pumps
Single-ph.	Three-ph.		
DCm 42	DC 42	16	24
DCm 43	DC 43	16	24
-	DC 44	16	24

MATERIALS AND COMPONENTS

1 Pump body	Cast iron with cataphoresis
2 Grid	Stainless steel AISI 304
3 Cover	Cast iron with cataphoresis
4 Impeller	Stainless steel AISI 304 micro-cast
5 Motor holder	Cast iron with cataphoresis
6 Motor cover	Cast iron with cataphoresis
7 Motor shaft	Stainless steel AISI 431

8 Double mechanical seal with interposed oil chamber

Seal	Shaft	Location	Materials
STA-24	Ø 24 mm	Motor side	Ceramic / Graphite / NBR
STA-22 SIC	Ø 22 mm	Pump side	SiC / SiC / NBR

9 Motor Eléctrico

DCm: single-phase 220 V - 60 Hz or 110 V - 60 Hz
with thermal motor protection

DC: three-phase 380 V - 60 Hz or 440 V - 60 Hz
with winding integrated thermal motor protection to
be connected to the control panel

- Insulation: class F
- Protection rating: IP X8

Control panel
(standard for single-phase versions)

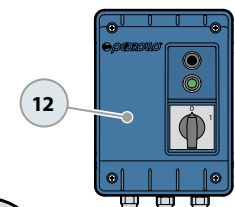

10 Power cord

※ 10 metres 'H07 RN-F' type

11 Float switch

12 Switch cabinet

(exclusive to single-phase models)

13 Tilting device for the float cable

(exclusive to single-ph. models) Patent No. IT0001428923

